

ARGENT & LUNDY CERTIFICATE OF AUTHORIZATION NO. 080442 (VALID THROUGH 08/31/2021)

PRELIMINARY
NOT FOR CONSTRUCTION

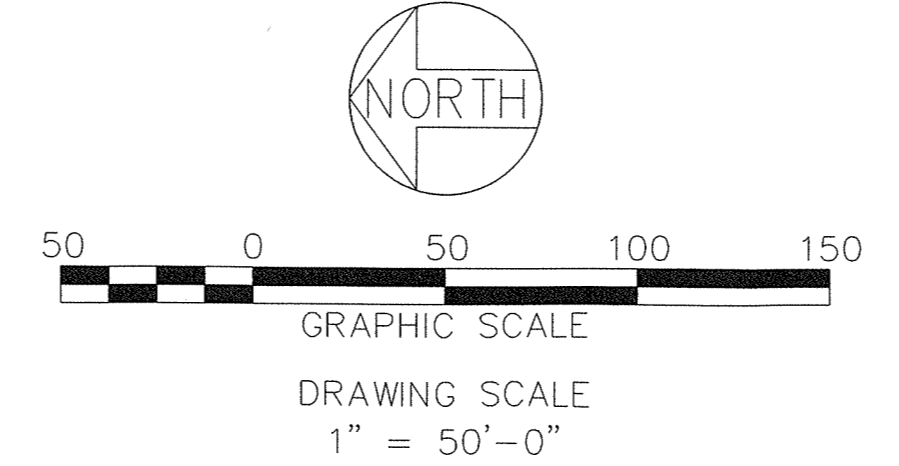

LEGEND	
	EXISTING CONTOUR
	FINISHED GRADE MINOR CONTOUR
	FINISHED GRADE MAJOR CONTOUR
	SILT FENCE (NOTE 7)
	SITE FENCE
	CORRUGATED HIGH DENSITY POLYETHYLENE PIPE

- NOTES**
- COORDINATE SYSTEM IS NEW YORK STATE PLANE WEST, US FOOT.
 - TOPOGRAPHY FOR THE SITE WAS OBTAINED FROM SAM, LLC.
 - PRIVILEGED AND CONFIDENTIAL ATTORNEY-CLIENT COMMUNICATION/ATTORNEY WORK PRODUCT PREPARED AT THE DIRECTION OF LEGAL COUNSEL.
 - IT IS A VIOLATION OF THE GUIDELINES FOR PROFESSIONAL ENGINEERING PRACTICE IN NEW YORK STATE LAW FOR ANY PERSON TO ALTER THIS DOCUMENT IN ANY WAY, UNLESS ACTING UNDER THE DIRECTION OF A LICENSED PROFESSIONAL ENGINEER.
 - CULVERT AND RIPRAP SHALL BE PLACED PER DETAIL 2, DRAWING 13666-004-C1-0116. FLARED END SECTIONS SHALL BE PLACED AT EACH END OF THE CULVERT.
 - FOR TEMPORARY CONSTRUCTION ENTRANCE DETAIL, REFER TO ECI ENGINEERING SERVICES, P.C. DRAWING E31-D-002-105, DATED 11/19/19.
 - FOR SILT FENCE DETAIL, REFER TO ECI ENGINEERING SERVICES, P.C. DRAWING E31-D-002-105, DATED 11/19/19.
 - FILL QUANTITY DOES NOT INCLUDE ANY FILL COMPACTION FACTOR OR ACCOUNT FOR REMOVAL OF TOPSOIL OR OTHER UNSUITABLE MATERIAL.

ESTIMATED QUANTITIES	
PAD:	TOTAL FILL VOLUME = 13,600 CY
#1 STONE	= 1,575 CY
#2 STONE	= 8,820 CY
TYPE 2 SUBBASE	= 4,200 CY
TOPSOIL STRIPPING (6")	= 3,235 CY
FILL VOLUME WITHOUT STONE	= 1,005 CY (NOTE 8)
CUT	= 6,000 CY
ROAD:	TOTAL FILL VOLUME = 1,245 CY
#1 STONE	= 155 CY
#2 STONE	= 675 CY
TYPE 2 SUBBASE	= 415 CY
TOPSOIL STRIPPING (6")	= 425 CY
FILL VOLUME WITHOUT STONE	= 0 CY (NOTE 8)
CUT	= 620 CY

CONTRACTOR/INSTALLER SHALL TAKE ALL APPROPRIATE PRECAUTIONS TO ENSURE THE SAFETY OF ALL PEOPLE LOCATED ON THE WORK SITE, INCLUDING CONTRACTOR'S/INSTALLER'S PERSONNEL (OR THAT OF ITS SUBCONTRACTOR(S)) PERFORMING THE WORK.

UNDERGROUND OR EMBEDDED UTILITIES MAY BE LOCATED WITHIN OR ADJACENT TO THE AREA IN WHICH EXCAVATION, DEMOLITION, FOUNDATION, OR MODIFICATION WORK IS TO BE PERFORMED.

REFERENCES RELATING TO THE UNDERGROUND OR EMBEDDED UTILITIES ARE PROVIDED TO ASSIST THE CONTRACTOR/INSTALLER IN THE FIELD LOCATING THOSE UTILITIES AND OTHER POSSIBLE UNDERGROUND OR EMBEDDED INTERFERENCES WITH THE WORK.

THE CONTRACTOR/INSTALLER SHALL EXERCISE DUE CAUTION DURING ALL EXCAVATION/FOUNDATION/DEMOLITION WORK.

NO	DATE	REVISIONS AND RECORD OF ISSUE	DRWN	REV'D	APPR	COMP	APP'D	KVP	DATE
D	12/19/19	PRELIMINARY RELEASE - ISSUED FOR PERMITS	CAF	JTP	KVP	S&L			
C	10/25/19	PRELIMINARY RELEASE - ISSUED FOR REVIEW	CAF	JTP	KVP	S&L			
B	03/13/19	PRELIMINARY RELEASE - ISSUED FOR REVIEW	CAF	JTP	KVP	S&L			
A1	04/17/18	PRELIMINARY RELEASE - FOR INFORMATION	CAF	VBP	KVP	S&L			
A	03/30/18	PRELIMINARY RELEASE - FILING SKETCH	CAF	VBP	KVP	S&L			

SCALE: 1"=50'

PREP: CAF CHKD: VBP

DATE: 03/30/2018

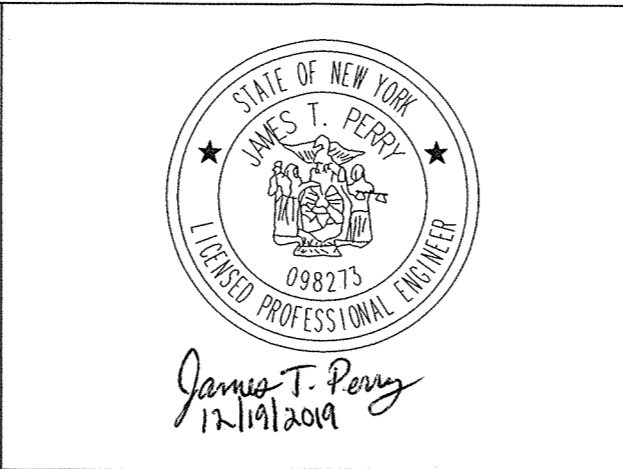

CONTRACTOR/INSTALLER SHALL TAKE ALL APPROPRIATE PRECAUTIONS TO ENSURE THE SAFETY OF ALL PEOPLE LOCATED ON THE WORK SITE, INCLUDING CONTRACTOR'S/INSTALLER'S PERSONNEL (OR THAT OF ITS SUB-CONTRACTOR(S)) PERFORMING THE WORK.

ANY MODIFICATION OR ADDITION TO THIS DRAWING BY ANY ORGANIZATION OTHER THAN ARGENT & LUNDY IS NOT THE RESPONSIBILITY OF ARGENT & LUNDY.

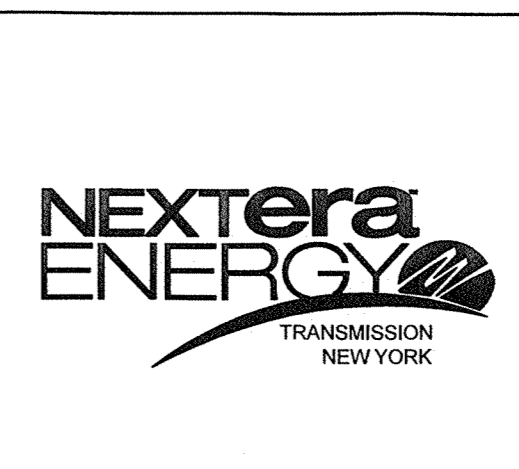

NEXTERA ENERGY TRANSMISSION NEW YORK, INC
EMPIRE STATE LINE
E. STOLLE SWITCHYARD
SITE GRADING PLAN
13666-004-C1-0115

CULVERT BEDDING AND BACKFILL NOTES

- CULVERT BEDDING AND BACKFILL MATERIAL SHALL MEET THE REQUIREMENTS OF NYS DOT STANDARD SPECIFICATIONS TABLE 703-4, SIZE NO. 1.
- SOFT TRENCH BOTTOM:
IF THE BOTTOM OF THE TRENCH IS SOFT, OVER EXCAVATE UP TO 2'-0" AS SPECIFIED BY THE PURCHASER AND REPLACE WITH "GRANULAR BEDDING MATERIAL" COMPACTED TO 90% ASTM D1557.

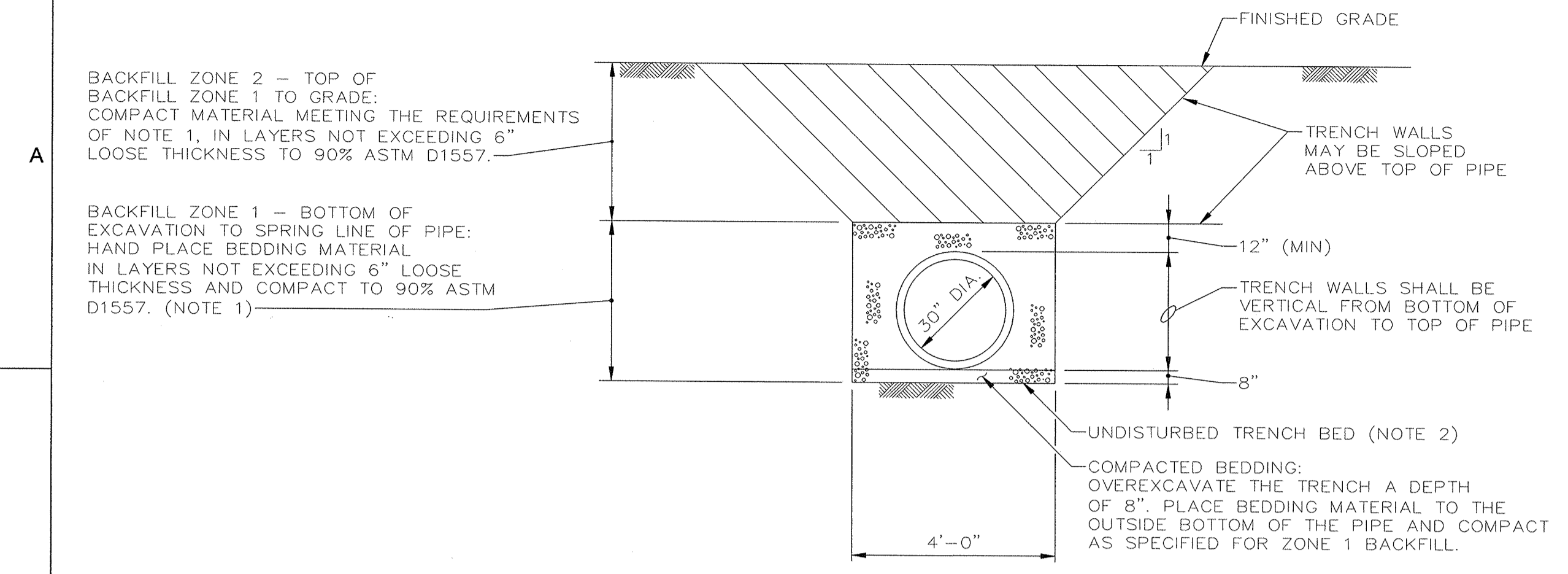

CULVERT BEDDING AND BACKFILL PLACEMENT
DETAIL 1
N.T.S.

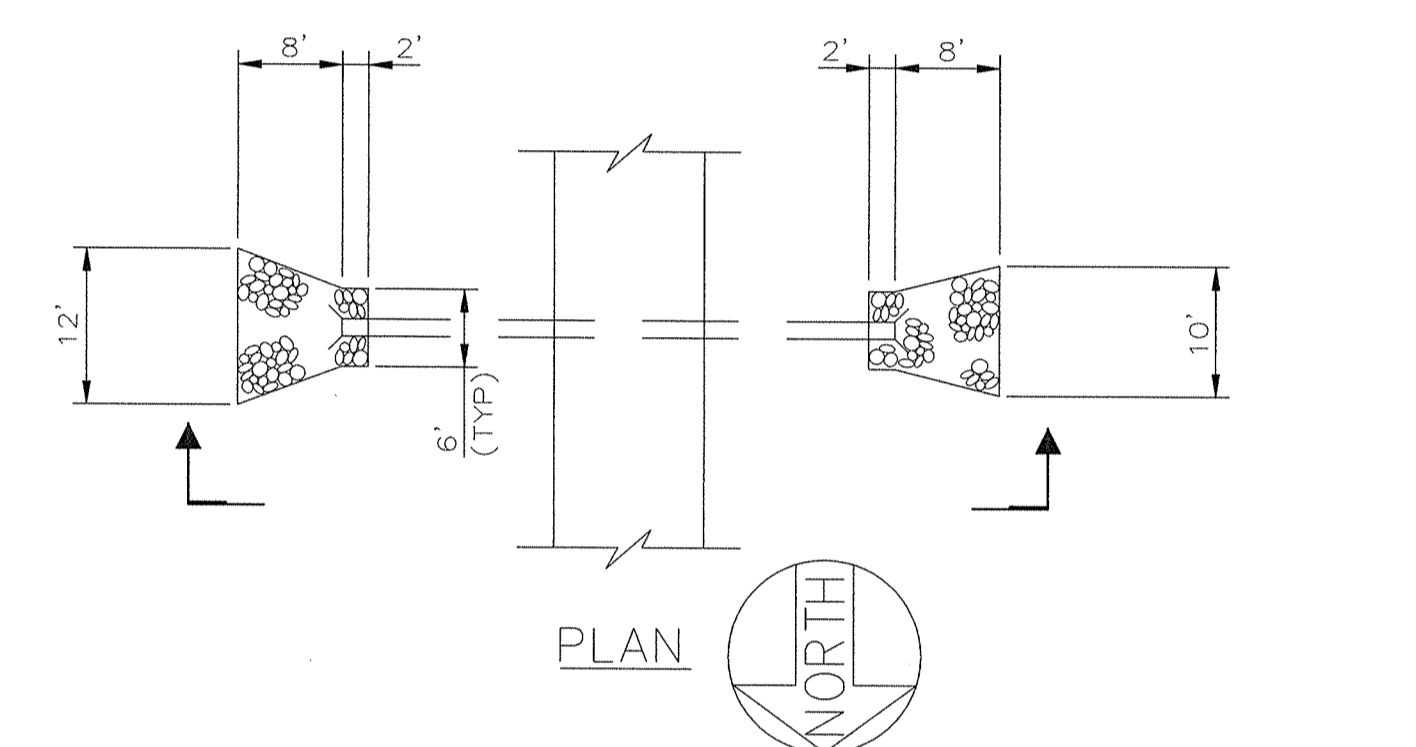

PLAN
NORTH

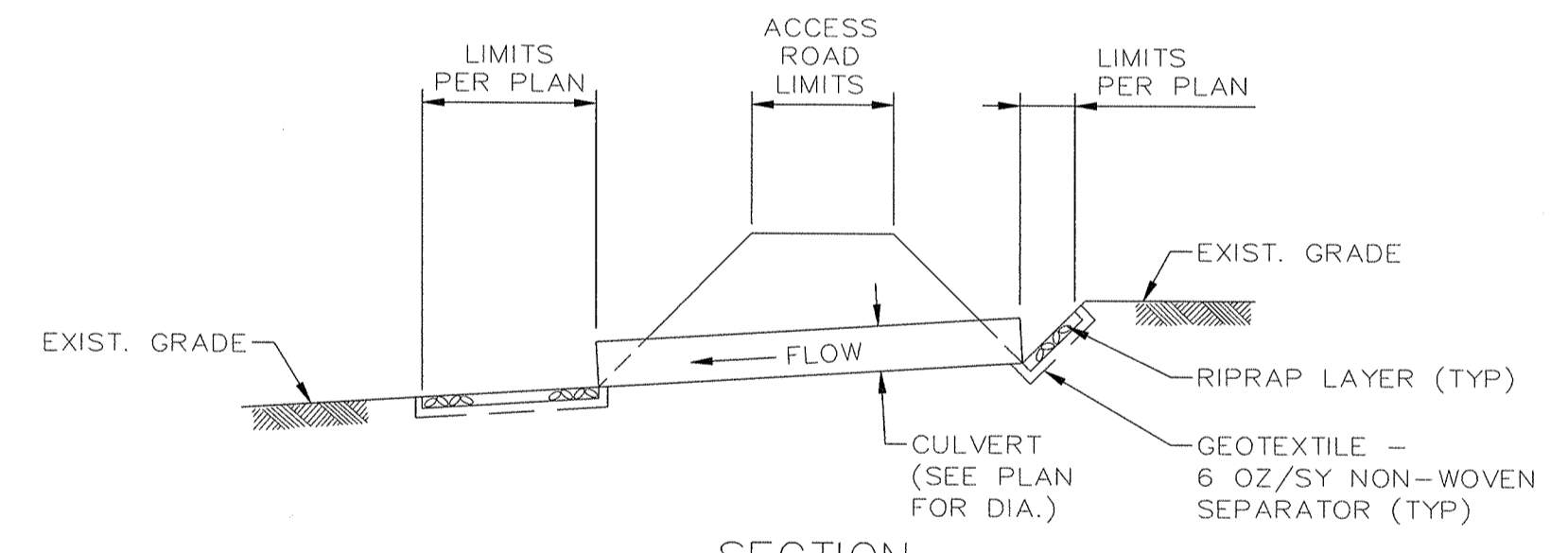

SECTION
(LOOKING SOUTH)
ACCESS ROAD CULVERT

DETAIL 2
N.T.S.

- DETAIL 2 NOTES:**
- RIPRAP SHALL CONSIST OF 18" THICK FINE STONE PER NYS DOT TABLE 733-21A.
 - CULVERT BEDDING AND BACKFILL SHALL BE PLACED IN ACCORDANCE WITH DETAIL 1.

LEGEND

NOTES

- NATIONAL GRID (NG), TOGETHER WITH THE CONSULTING FIRM (ENVIRONMENTAL DESIGN & RESEARCH (EDR)) PREPARED A NYSDEC APPROVED STORMWATER MANAGEMENT PROTOTYPE SYSTEM (SYSTEM), WHICH MAY BE APPLICABLE TO SUBSTATION PROJECTS. THE USER ASSUMES THE SOLE RESPONSIBILITY FOR THE USE OF THIS SYSTEM, ITS APPLICABILITY TO THE PROJECT SITE, AND THE VERIFICATION OF APPROPRIATE USE AND COMPLIANCE WITH VILLAGE, TOWN, CITY, COUNTY, STATE, AND FEDERAL STORMWATER REQUIREMENTS FOR THIS LOCATION.
- THE GEOTECHNICAL REPORT FOR THE PROJECT WAS PREPARED BY WMA ENGINEERING DPC, DATED MARCH 29, 2019.
- SITE PREPARATION SHALL INCLUDE THE REMOVAL OF ALL EXISTING TOPSOIL AND FILL/DISTURBED SURFACE SOIL, AND ANY LOOSE OR SOFT INDIGENOUS SOILS PRIOR TO ANY FILL MATERIAL PLACEMENT.
- ALL FILL MATERIAL FOR THE PROJECT SHALL MEET THE REQUIREMENTS FOR STRUCTURAL FILL OR SUITABLE GRANULAR FILL AS INDICATED IN APPENDIX E OF THE GEOTECHNICAL REPORT. ALL SITE FILLING OPERATIONS SHALL BE MONITORED AND TESTED BY QUALIFIED GEOTECHNICAL ENGINEERING PERSONNEL.
- NO FILL MATERIAL PLACEMENT SHALL BE ALLOWED OVER FILL MATERIAL WHICH HAS NOT BEEN PROPERLY PLACED AND COMPACTED OR ON WET, SOFT, UNSTABLE OR FROZEN SUBGRADES.
- EXPOSED SUBGRADES SHALL BE CAREFULLY INSPECTED, PROOFROLLED, AND EVALUATED BY QUALIFIED GEOTECHNICAL ENGINEERING PERSONNEL PRIOR TO FILL PLACEMENT.
- PROOFROLLING SHALL BE PERFORMED PRIOR TO FILL PLACEMENT USING A SMOOTH DRUM ROLLER, WEIGHING AT LEAST 10 TONS. THE ROLLER SHALL BE OPERATED IN STATIC MODE, AND COMPLETE AT LEAST 2 PASSES OVER THE EXPOSED SUBGRADES. PROOFROLLING MAY BE WAIVED IN THE PRESENCE OF WET SUBGRADES, IF DIRECTED BY QUALIFIED GEOTECHNICAL ENGINEERING PERSONNEL.
- IT IS RECOMMENDED THAT AREAS WITH FILL MATERIAL EXCEEDING 2-3 FEET BE COMPLETED AT LEAST 6 MONTHS IN ADVANCE OF SPREAD AND MAT FOUNDATION, FLOOR SLAB, AND UTILITY CONSTRUCTION, TO HELP LIMIT POST-CONSTRUCTION SETTLEMENT.
- IT IS A VIOLATION OF THE GUIDELINES FOR PROFESSIONAL ENGINEERING PRACTICE IN NEW YORK STATE LAW FOR ANY PERSON TO ALTER THIS DOCUMENT IN ANY WAY, UNLESS ACTING UNDER THE DIRECTION OF A LICENSED PROFESSIONAL ENGINEER.
- CLEARING AND STRIPPING OF ALL TOPSOIL AND SURFICIAL ORGANIC MATTER WITHIN THE PAD AND ROAD LIMITS IS REQUIRED. THE THICKNESS OF TOPSOIL IS ESTIMATED AS 6". IF ANY EXISTING FILL MATERIAL IS DEEMED UNSUITABLE BY THE GEOTECHNICAL ENGINEER, IT SHALL BE UNDERCUT AND REPLACED WITH STRUCTURAL FILL MATERIAL.
- ALL SUBGRADES SHALL BE PROOFROLLED WITH A 10-TON OR HEAVIER VIBRATORY DRUM ROLLER, AT A SPEED OF 2 MPH OR LESS. ANY SOFT AREAS SHALL BE UNDERCUT AND REPLACED WITH STRUCTURAL FILL AS DIRECTED BY GEOTECHNICAL ENGINEER. SUBGRADE SHALL BE APPROVED BY THE GEOTECHNICAL ENGINEER PRIOR TO PLACEMENT OF ANY FILL MATERIAL.
- SEED MIXTURE:

MIXTURES	RATE PER ACRE (LBS)	RATE PER 1,000 SQ. FT. (LBS)
WHITE CLOVER OR LADINO CLOVER	8	0.20
SMOOTH BROMEGRASS	20	0.45
CREeping RED FESCUE	2	0.05
TOTAL	30	0.70
- EROSION CONTROL BLANKETING SHALL BE PLACED ALONG ALL SIDESLOPES AND OTHER AREAS NOT STABILIZED BY STONE AND SEEDED PER NOTE 12.

REFERENCE DRAWINGS

CONTRACTOR/INSTALLER SHALL TAKE ALL APPROPRIATE PRECAUTIONS TO ENSURE THE SAFETY OF ALL PEOPLE LOCATED ON THE WORK SITE, INCLUDING CONTRACTOR'S/INSTALLER'S PERSONNEL (OR THAT OF ITS SUBCONTRACTOR(S)) PERFORMING THE WORK.

UNDERGROUND OR EMBEDDED UTILITIES MAY BE LOCATED WITHIN OR ADJACENT TO THE AREA IN WHICH EXCAVATION, DEMOLITION, FOUNDATION, OR MODIFICATION WORK IS TO BE PERFORMED.

REFERENCES RELATING TO THE UNDERGROUND OR EMBEDDED UTILITIES ARE PROVIDED TO ASSIST THE CONTRACTOR/INSTALLER IN THE FIELD LOCATING THOSE UTILITIES AND OTHER POSSIBLE UNDERGROUND OR EMBEDDED INTERFERENCES WITH THE WORK.

THE CONTRACTOR/INSTALLER SHALL EXERCISE DUE CAUTION DURING ALL EXCAVATION/FOUNDATION/DEMOLITION WORK.

SARGENT & LUNDY CERTIFICATE OF AUTHORIZATION NO. 080442 (VALID THROUGH 08/31/2021)

PRELIMINARY
NOT FOR CONSTRUCTION

SCALE:	NONE	
DATE	12/19/19	10/25/19
REVISIONS AND RECORD OF ISSUE	DRWN	REV'D
DATE	12/19/19	10/25/19

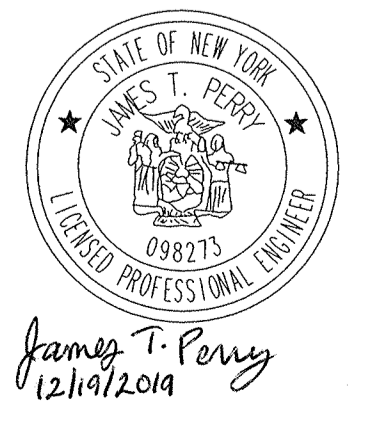

CONTRACTOR/INSTALLER SHALL TAKE ALL APPROPRIATE PRECAUTIONS TO ENSURE THE SAFETY OF ALL PEOPLE LOCATED ON THE WORK SITE, INCLUDING CONTRACTOR'S/INSTALLER'S PERSONNEL (OR THAT OF ITS SUB-CONTRACTOR(S)) PERFORMING THE WORK.

ANY MODIFICATION OR ADDITION TO THIS DRAWING BY ANY ORGANIZATION OTHER THAN SARGENT & LUNDY IS NOT THE RESPONSIBILITY OF SARGENT & LUNDY.



NEXTERA ENERGY TRANSMISSION NEW YORK, INC
EMPIRE STATE LINE
E. STOLLE SWITCHYARD
SITE GRADING DETAILS

13666-004-C1-0116

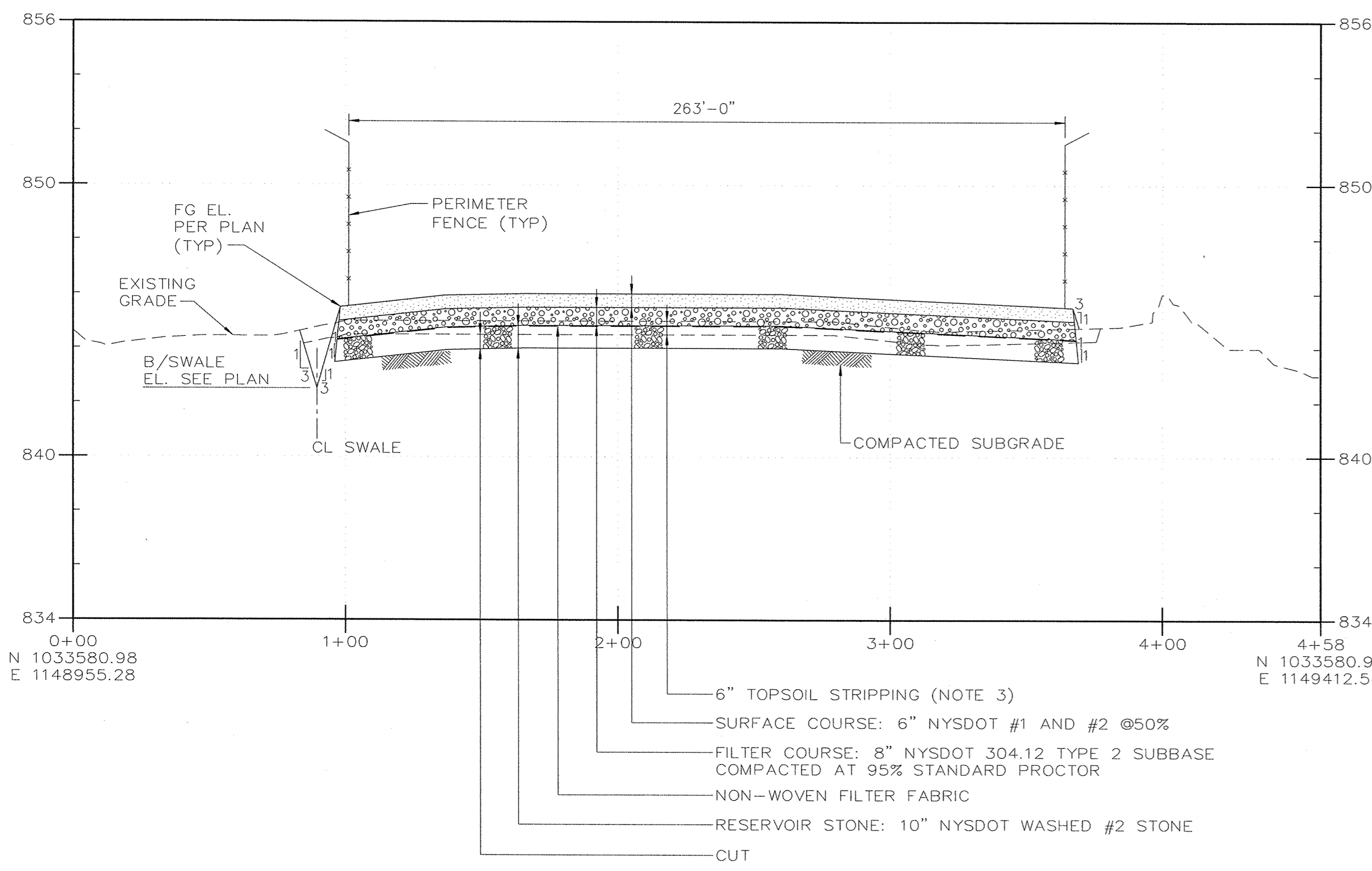

SECTION A
 HORZ. SCALE: 1"=40' VERT. SCALE: 1"=4'

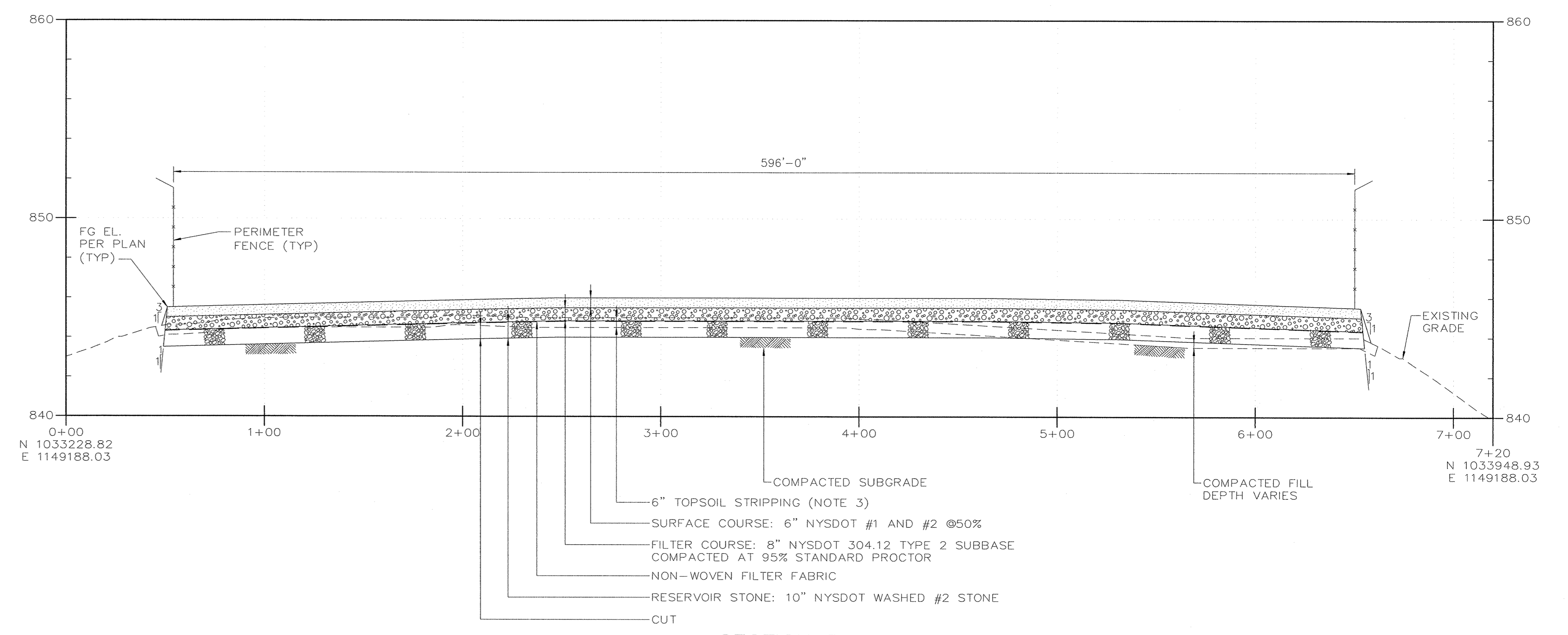

SECTION B
 HORZ. SCALE: 1"=40' VERT. SCALE: 1"=4'

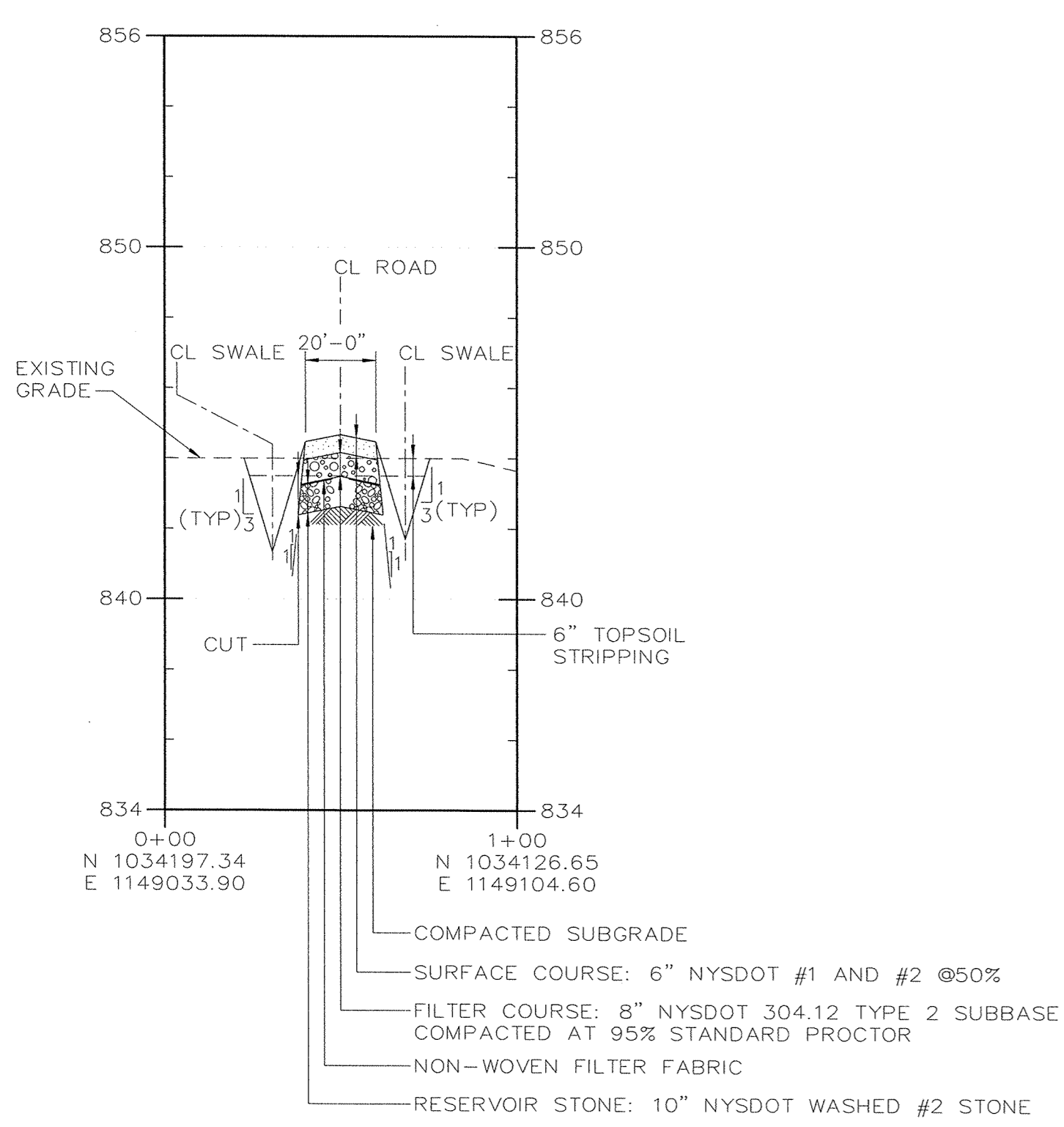

SECTION C
 HORZ. SCALE: 1"=40' VERT. SCALE: 1"=4'

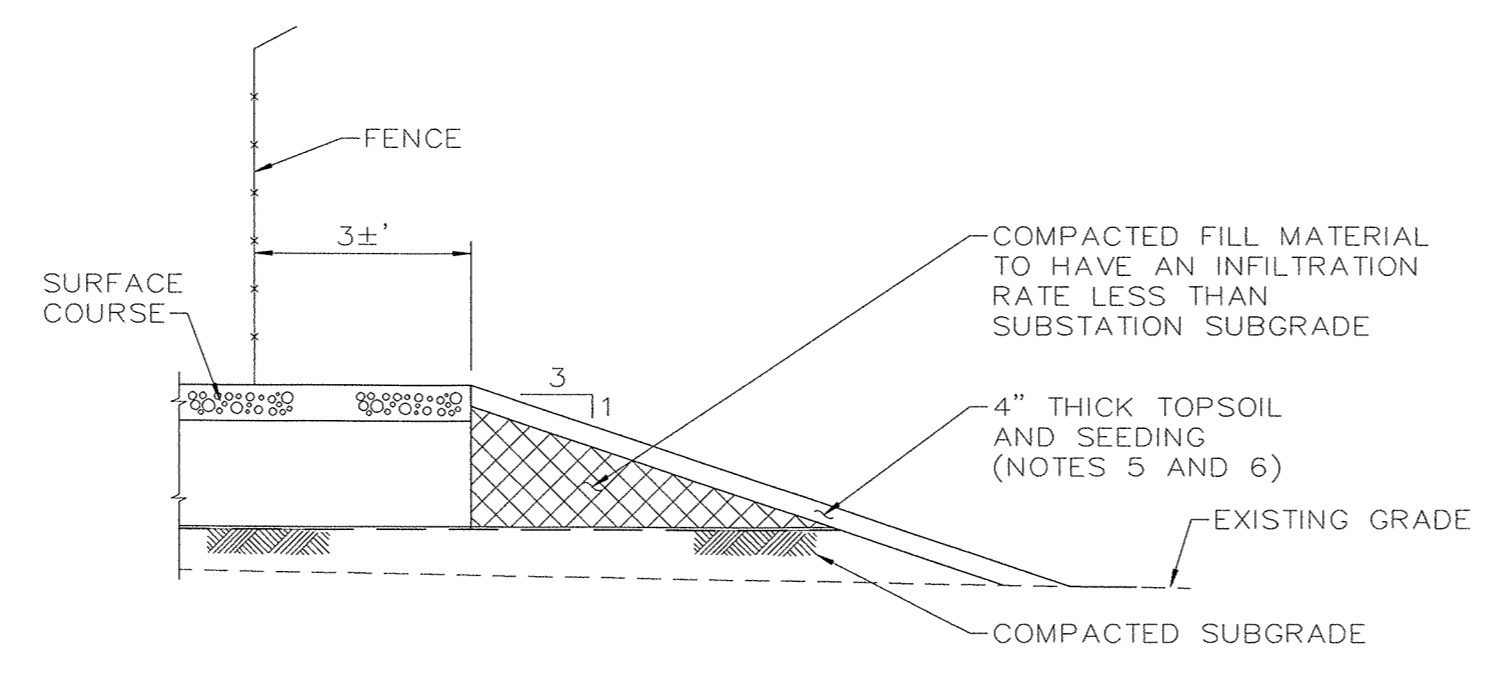

TYPICAL PAD EDGE DETAIL
DETAIL D

NOTES

- FOR SITE GRADING PLAN, SEE DRAWING 13666-004-C1-0115.
- IT IS A VIOLATION OF THE GUIDELINES FOR PROFESSIONAL ENGINEERING PRACTICE IN NEW YORK STATE LAW FOR ANY PERSON TO ALTER THIS DOCUMENT IN ANY WAY, UNLESS ACTING UNDER THE DIRECTION OF A LICENSED PROFESSIONAL ENGINEER.
- CLEARING AND STRIPPING OF ALL TOPSOIL AND SURFICIAL ORGANIC MATTER WITHIN THE PAD AND ROAD LIMITS IS REQUIRED. THE THICKNESS OF TOPSOIL IS ESTIMATED AS 6". HOWEVER, THE ACTUAL THICKNESS MAY VARY. IF ANY EXISTING FILL MATERIAL IS DEEMED UNSUITABLE BY THE GEOTECHNICAL ENGINEER, IT SHALL BE UNDERCUT AND REPLACED WITH STRUCTURAL FILL MATERIAL.
- ALL SUBGRADES SHALL BE PROFFROLLED WITH A 10-TON OR HEAVIER VIBRATORY DRUM ROLLER, AT A SPEED OF 2 MPH OR LESS. ANY SOFT AREAS SHALL BE UNDERCUT AND REPLACED WITH STRUCTURAL FILL AS DIRECTED BY GEOTECHNICAL ENGINEER. SUBGRADE SHALL BE APPROVED BY THE GEOTECHNICAL ENGINEER PRIOR TO PLACEMENT OF ANY FILL MATERIAL.
- SEED MIXTURE:

MIXTURES	RATE PER ACRE (LBS)	RATE PER 1,000 SQ. FT. (LBS)
WHITE CLOVER OR LADINO CLOVER	8	0.20
SMOOTH BROMEGRASS	20	0.45
CREEPING RED FESCUE	2	0.05
TOTAL	30	0.70
- EROSION CONTROL BLANKETING SHALL BE PLACED ALONG ALL SIDESLOPES AND OTHER AREAS NOT STABILIZED BY STONE AND SEED PER NOTE 5.
- PRIVILEGED AND CONFIDENTIAL ATTORNEY-CLIENT COMMUNICATION/ATTORNEY WORK PRODUCT PREPARED AT THE DIRECTION OF LEGAL COUNSEL.

SARGENT & LUNDY CERTIFICATE OF AUTHORIZATION NO. 080442 (VALID THROUGH 08/31/2021)

PRELIMINARY
 NOT FOR CONSTRUCTION

CONTRACTOR/INSTALLER SHALL TAKE ALL APPROPRIATE PRECAUTIONS TO ENSURE THE SAFETY OF ALL PEOPLE LOCATED ON THE WORK SITE, INCLUDING CONTRACTOR'S/INSTALLER'S PERSONNEL (OR THAT OF ITS SUBCONTRACTOR(S)) PERFORMING THE WORK.

UNDERGROUND OR EMBEDDED UTILITIES MAY BE LOCATED WITHIN OR ADJACENT TO THE AREA IN WHICH EXCAVATION, DEMOLITION, FOUNDATION, OR MODIFICATION WORK IS TO BE PERFORMED.

REFERENCES RELATING TO THE UNDERGROUND OR EMBEDDED UTILITIES ARE PROVIDED TO ASSIST THE CONTRACTOR/INSTALLER IN THE FIELD LOCATING THOSE UTILITIES AND OTHER POSSIBLE UNDERGROUND OR EMBEDDED INTERFERENCES WITH THE WORK.

THE CONTRACTOR/INSTALLER SHALL EXERCISE DUE CAUTION DURING ALL EXCAVATION/FOUNDATION/DEMOLITION WORK.

NO	DATE	REVISIONS AND RECORD OF ISSUE	DRWN	REV'D	APPR	COMP	APP'D	KVP	DATE
E	12/19/19	PRELIMINARY RELEASE - ISSUED FOR PERMITS	CAF	JTP	KVP	S&L			
D	10/25/19	PRELIMINARY RELEASE - ISSUED FOR REVIEW	CAF	JTP	KVP	S&L			
C	03/13/19	PRELIMINARY RELEASE - ISSUED FOR REVIEW	CAF	JTP	KVP	S&L			
B	05/25/18	PRELIMINARY RELEASE - FILING SKETCH	CAF	VBP	KVP	S&L			
A1	04/17/18	PRELIMINARY RELEASE - FOR INFORMATION	CAF	VBP	KVP	S&L			
A	03/30/18	PRELIMINARY RELEASE - FILING SKETCH	CAF	VBP	KVP	S&L			
NO	DATE	REVISIONS AND RECORD OF ISSUE	DRWN	REV'D	APPR	COMP	APP'D	KVP	DATE: 03/30/2017

SCALE:
 1"=40'
 0 40



CONTRACTOR/INSTALLER SHALL TAKE ALL APPROPRIATE PRECAUTIONS TO ENSURE THE SAFETY OF ALL PEOPLE LOCATED ON THE WORK SITE, INCLUDING CONTRACTOR'S/INSTALLER'S PERSONNEL (OR THAT OF ITS SUB-CONTRACTOR(S)) PERFORMING THE WORK.

ANY MODIFICATION OR ADDITION TO THIS DRAWING BY ANY ORGANIZATION OTHER THAN SARGENT & LUNDY IS NOT THE RESPONSIBILITY OF SARGENT & LUNDY.



NEXTERA ENERGY TRANSMISSION NEW YORK, INC
EMPIRE STATE LINE
E. STOLLE SWITCHYARD
SITE GRADING SECTIONS AND DETAILS

13666-004-C1-0120